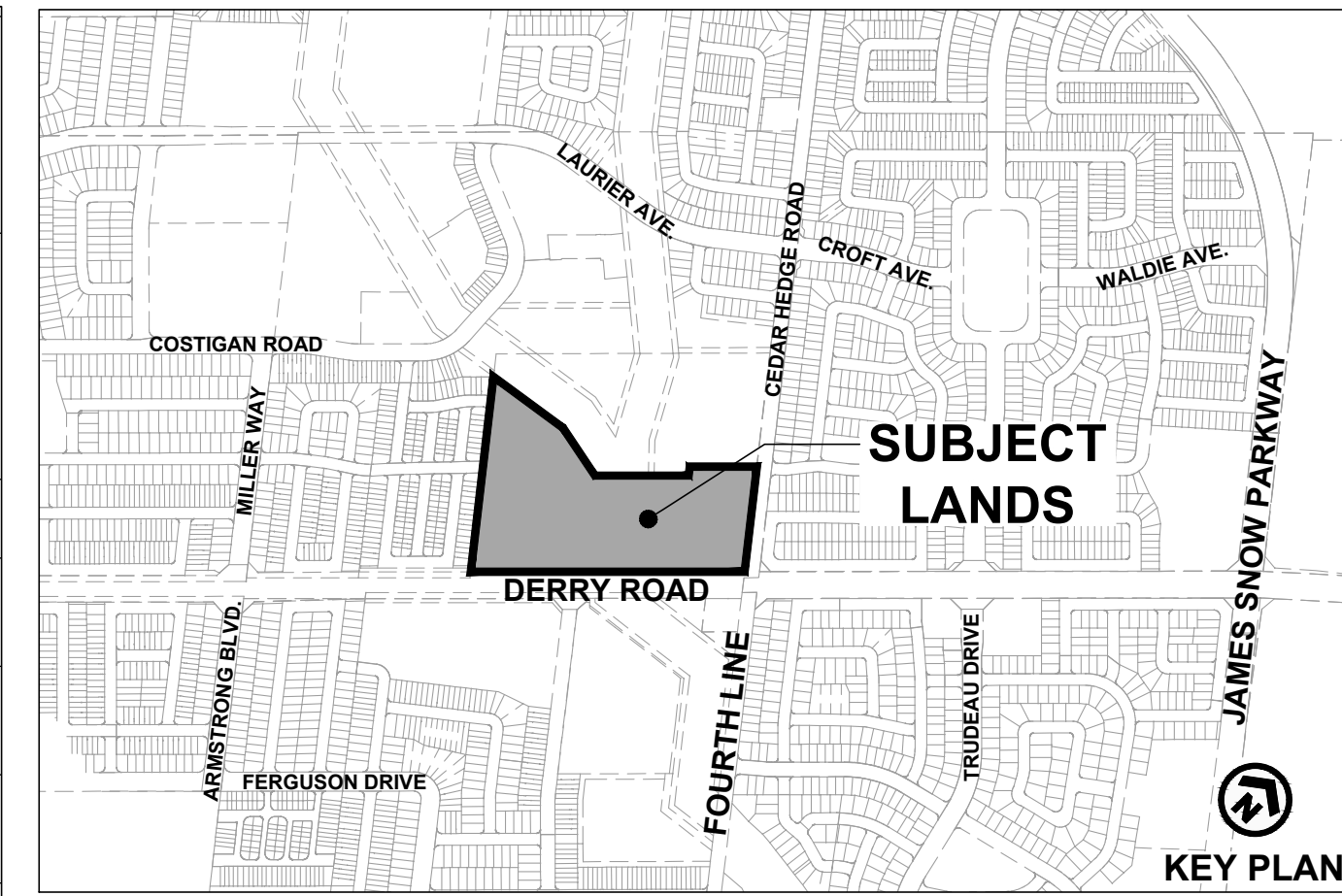

FIGURE 2
DS-082-24



**DRAFT PLAN OF SUBDIVISION
BRANTHAVEN WATERLOO INC.**
FILE # 24T-

PART OF LOT 11, CONCESSION 4,
NEW SURVEY
TOWN OF MILTON
REGIONAL MUNICIPALITY OF HALTON

OWNERS CERTIFICATE
I HEREBY AUTHORIZE GLEN SCHNARR & ASSOCIATES INC. TO PREPARE AND SUBMIT THIS DRAFT PLAN OF SUBDIVISION TO THE TOWN OF MILTON FOR APPROVAL.

SIGNED _____ DATE: _____
ARDEN SEMPER, A.S.O.
BRANTHAVEN WATERLOO INC.

SURVEYORS CERTIFICATE
I HEREBY CERTIFY THAT THE BOUNDARIES OF THE LANDS TO BE SUBDIVIDED AS SHOWN ON THIS PLAN AND THEIR RELATIONSHIP TO ADJACENT LANDS ARE CORRECTLY AND ACCURATELY SHOWN.

SIGNED _____ DATE: _____
ROSS DENBROEDER, OLS
R-PE SURVEYING LTD.
643 CHRISLEA ROAD, SUITE 7
WOODBRIDGE ON, L4L 8A3
PHONE: (416) 635-5000
WEB: www.r-pe.ca

ADDITIONAL INFORMATION
(UNDER SECTION 51(17) OF THE PLANNING ACT) INFORMATION REQUIRED BY CLAUSES A,B,C,D,E,F,G,J & L ARE SHOWN ON THE DRAFT AND KEY PLANS.

- H) MUNICIPAL AND PIPED WATER TO BE PROVIDED
- I) SANDY LOAM AND CLAY LOAM
- K) SANITARY AND STORM SEWERS TO BE PROVIDED

LAND USE	BLOCKS	AREA (ha)	AREA (ac)	UNITS	DENSITY (UPHA)
STREET TOWNHOUSES - 7.01m (23')	1-7	0.63	1.56	30	47.62
MEDIUM DENSITY RESIDENTIAL	8,9	3.29	8.13		
NHS CHANNEL	10	0.76	1.88		
NHS CHANNEL BUFFER	11,12	0.19	0.47		
BUFFER	13	0.003	0.007		
VILLAGE SQUARE	14	0.53	1.31		
ROAD WIDENING	15	0.21	0.52		
0.3m RESERVE	16,17	0.01	0.02		
16.0m R.O.W. - (341m LENGTH)		0.57	1.41		
TOTAL	17	6.19	15.30		

NOTES
- PAVEMENT IS DIAGRAMMATIC ONLY

