



Appendix 3  
Photographic Record \_ Heritage Attributes \_ 11668 First Line



Location Map\_ 11668 First Line

**NASSAGAWEYA**

- CON 1
- PT LOT 20
- IRREG
- 92.62AC

CON I CON II

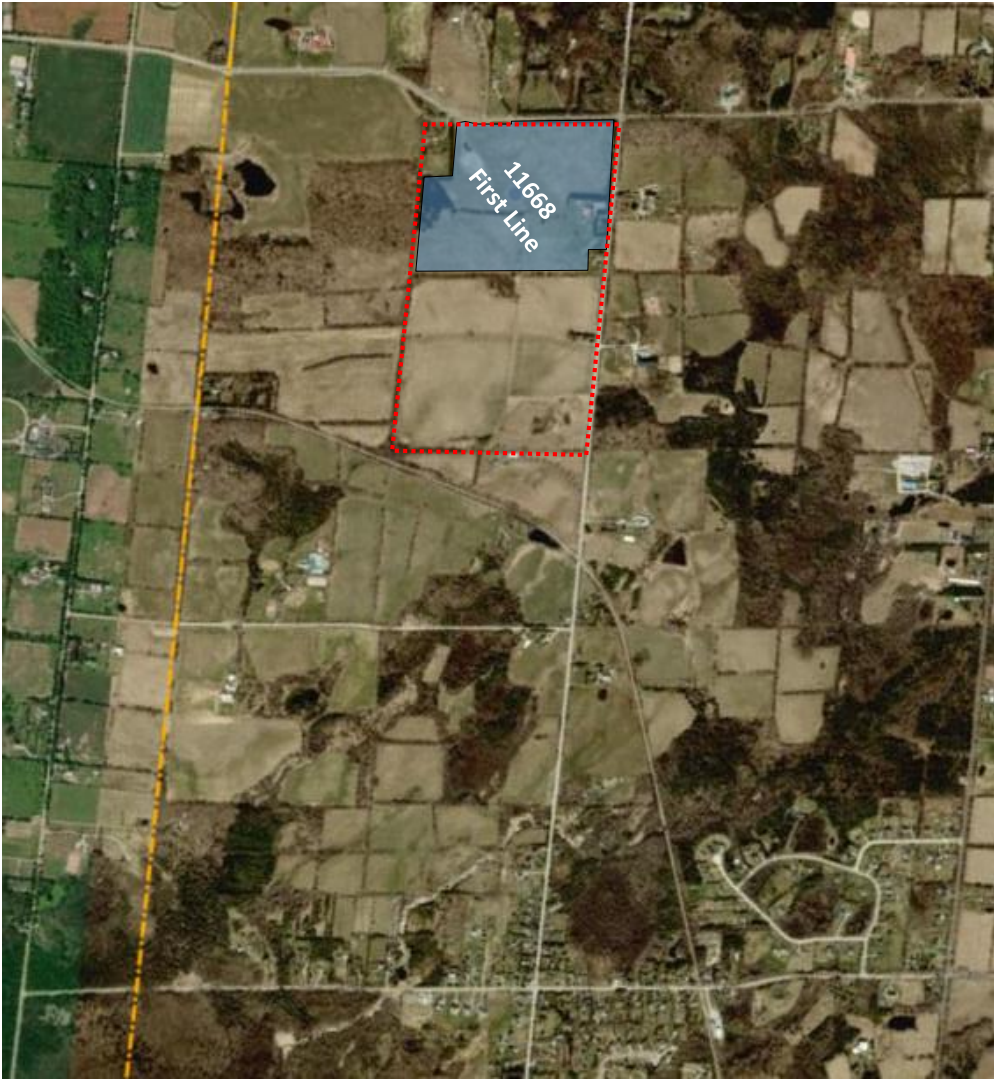

Lot 20  
Lot 19

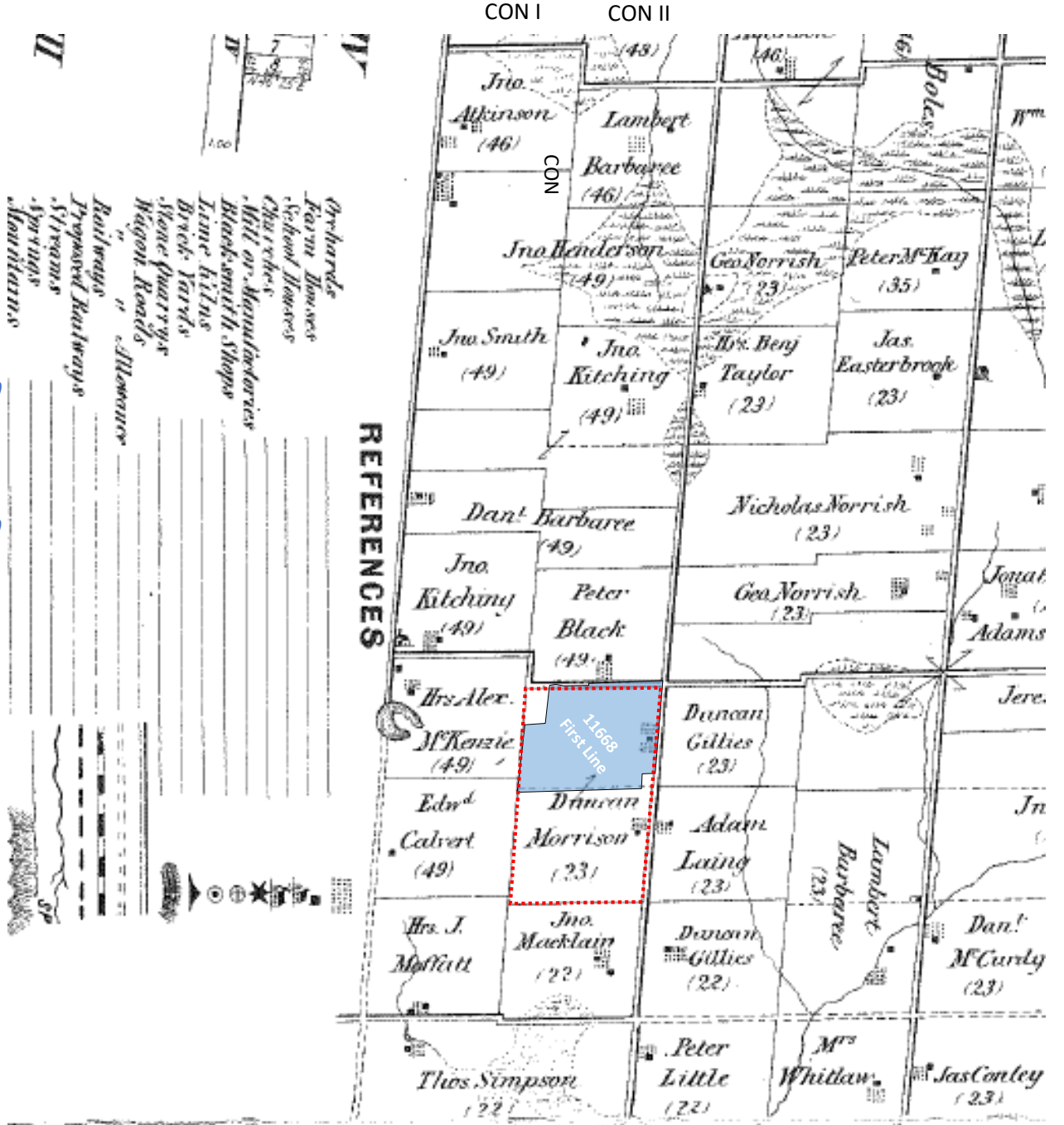

Lot 20  
Lot 19

# Milton Heritage Inventory Record

- This property was a Listed heritage resource since 2006.

MILTON L.A.C.A.C. HERITAGE INVENTORY	
<b>BUILDING TYPE:</b> Rural residential	<b>INVENTORY #:</b>
<b>ADDRESS:</b> 11668 First Line, NASSAGAWEYA	(CON 1-LOT 20 E $\frac{1}{2}$ )
<b>BUILDING NAME:</b>	<b>CONSTRUCTION DATE:</b> 1846
<b>ORIGINAL USE:</b> Farmhouse	<b>SOURCE:</b> stone inscription
<b>PRESENT USE:</b> House	Registry Office - land transactions
<b>DESIGNATION:</b>	Oral source: Robert Stupart
HISTORY	
<p>It is believed that this regency style cottage was built in 1846 by George Calvert for his daughter, Mary. (initials, G.M.C. and B.J.F. inscribed in stone) There is an adjoining stone building to the side which is now vacant, but may have been previously occupied by farmhands.</p>	
ARCHITECTURAL COMMENTS	
<p><b>WALLS:</b> A one and one half storey building built from cut stone, even course, tooled finish, 5 bays and side brick chimney.</p> <p><b>ROOF:</b> A low hip roof with skylight, projecting eaves, moulded wood soffit and frieze, gable dormer addition with returned eaves &amp; palladian window.</p> <p><b>WINDOWS:</b> Double-hung windows with plain stone lintels and lug sills and shutters.</p> <p><b>DOORWAYS:</b> A centre doorway with entablature, pilasters, partial sidelights and a multi-light transom.</p> <p><b>PORCHES:</b></p> <p><b>OTHERS:</b> Once summer kitchen at rear turned into garage which is presently unused. Summer kitchen may have been added later to original building.</p>	

has been dead some years and his sons, William and Joseph, occupy the land. His eldest son, George, had been occupying the west-half of Lot 24, in the 5th Concession; he died last spring, his family are still there.

John Colquhoun, commonly pronounced Cohoun, came from Argyleshire, Scotland, in 1821, went first to Niagara, stopped there some time, then came back to Wellington Square and worked there some years. He took up Lot 27, in the 4th Concession, some-time about 1835, and spent the remainder of his life there. He died in 1887, aged ninety-four years. Him and his wife had been living together over sixty-six years; the old lady is still living on the farm in her ninety-fifth year, her health is good, she is blind, and very deaf, otherwise her faculties are unimpaired. I had the pleasure of visiting them on the sixty-six anniversary of their wedding and thought I was highly privileged.

Donald McIntyre appears to have come on to Lot 24, in the east-half of the 6th Concession, in 1831. I know but little about the man. It is said that his wife carried a basket of eggs (twenty-five dozen) to Wellington Square on her arm, took her pay in store goods, then walked back home without stopping for rest. This would be over twenty miles. Thomas Easterbrook bought the farm from the McIntyre family and sold it to James Campbell, he sold to Whitley, who still owns it. David Cargil and Benjamin Kean appear on the assessment roll for 1830 for the first time. Cargil has one acre cleared and Kean has two. **Edward and George Calvert about the same time on Lots 19 and 20, in the 1st Concession. George Calvert sold many years ago to John McLean, he to Duncan Morrison, Morrison's executors to Hugh Eveleigh, who**

13210  
4th Line

12527.  
5th line

11668  
1st line

still owns it. **Edward Calvert's son still owns part of his father's farm.** Thomas Locker, grandfather of the present Thomas Locker, was a very early settler here on Lot 31, in the 2nd Concession, he spent his days on the place. It has changed hands several times and is now in the market. His son John settled on the east-half of Lot 25, in the 3rd Concession, a few years after and his son Thomas is still there. Jeremiah Hirst, Lot 8, in the 2nd Concession, was a British soldier in the Duke of Wellington's time, and came here about 1833.

The names of the parties below appear on the assessment rolls for the first time as follows:—In 1830—Andrew Beaty, Lot 13, in the 2nd Concession; Anthony Ribble, Lot 14, in the 2nd Concession; George Curry, Lot 11, in the 4th Concession; Abraham Wallace, Lot 11, in the 4th Concession; Patrick Marshall, Lot 7, in the 4th Concession; Philip Kribbs, Lot 32, in the 6th Concession; George Black, Lot 21, in the 5th Concession; E. Blanchard, Lot 26, in the 5th Concession. In 1831—Andrew Murray, west-half of Lot 1, in the 6th Concession; Alexander Robertson, east-half Lot 1, in the 7th Concession; David Taggart, Lot 14, in the 3rd Concession; James Eakins Lot 16, in the 5th Concession; James Davidson, east-half of Lot 14, in the 2nd Concession, and east-half of Lot 11, in the 2nd Concession; Dugald Leitch, east-half of Lot 25, in the 7th Concession; William Weir, east-half of Lot 12, in the 3rd Concession; George Henry, west-quarter of Lot 10, in the 4th Concession; John Ingle, west-half of Lot 31, in the 4th Concession. In 1832—John Sprall, Lot 3, in the 6th Concession; William Proctor, east-half of Lot 4, in the 7th Concession; George Fonger, east-half of Lot 26, in the 7th Concession; Archibald Leitch, Lot 27, in the 6th Concession; John Ritchie, east-half

2680 #25 Side Rd

10526 10057  
Guelph line  
10115 Guelph line

10084 +  
105 20 2nd line  
35 Campbell Ave

14005 Guelph line

# Historical Books Record

PRE-PRODUCTION

## MICROFILMING SUMMARY SHEET

Land Registry Office I.D.: # 20

Registration Type: R

Municipality: HALTON

Township: NASSAGAWEYA

Book #: 1

Concession: 1

LOT FROM: \_\_\_\_\_ LOT TO: \_\_\_\_\_

Filed: JUNE 1999

Registration Number	Instrument	Date of Instrument	Registration Date	Grantor	Grantee	Consideration ETC	Land and Remarks
	Patent	01 Jul 1825		Crown	Thomas Bull		100 ac. E'ly 1/2
472 L	B & Sale	25 Jan 1837	31 May 1839	Thomas Bull & Wife	George Calvert		100 ac. E'ly 1/2
190 N	B & Sale	03 Sep 1841	01 Oct 1841	George Calvert	John Gillies		100 ac. E'ly 1/2
863 N	B & Sale	01 Apr 1842	02 May 1843	John Gillies	Mary Calvert		100 ac. E'ly 1/2
296 B	B & Sale	10 Dec 1858	14 Dec 1858	Mary Calvert & Husband	John McLean		100 ac. E'ly 1/2
642 B	B & Sale	19 Mar 1862	20 Mar 1862	John McLean & Wife	Duncan Morrison		100 ac. E'ly 1/2
2461 I	Deed	13 Feb 1886	16 Feb 1889	Donald McCraig & Archibald McKenzie, executors of will of Duncan Morrison, widow, 2nd part Mary Holmes & Marshall Holmes, her husband, 3rd part & Mary McKenzie, widow of 4th Part	Hugh Evelegh	\$7,500	100ac. E 1/2
3076 K	Deed	10 May 1890	26 May 1890	Hugh Evelegh & wife	Daniel Jones	\$6,000	100 ac. E1/2
6199 P	B & Sale	December 6, 1914	December 14, 1914	Catherine Jones, wisow & Kenneth McKenzie, executors will of Daniel Jones, deceased and the said Cartherine Jones, personally	Burdge G. Butts	\$7,000	100 ac. E 1/2 subj to mort. The grantors to get rent of lands up to 1st Apr 1915
	Grant	December 24, 1918	December 26, 1918	Burdge G. Butts & wife	Robert Marshall	\$7,500	100 ac. E1/2 Subj. to existing mort which grantee assumes
8807 R	Grant	September 23, 1939	October 2, 1939	Arnold Blair Marshall and James Roy Marshall, executors of Elizabeth Marshall wido deceased and said James Roy Marshall	Arnold Blair Marshall	Pem & \$1	100 ac. E 1/2 subj to mort. The grantors to get rent of lands up to 1st Apr 1915
9582	Grant	March 31, 1947	April 3, 1947	Arnold Blair Marshall & wife	Donald McKersie and Jean McKersie, his wife, jt.	\$8,000	100 ac. E 1/2
150630	Grant	March 31, 1947	April 29, 1947	Donald David McKersie and Jean McKersie, his wife	Wilson Jacob Snyder & Leona Mae Snyder, his wife, jt.	\$8,000	100 ac. E 1/2
355333	Grant	September 18, 1973	October 1, 1973	Wilson Jacob Snyder & Leona Mae Snyder, his wife	John Huempfner & Kathe Hyempfner, his wife jt.	\$2 & c.	PT E 1/2 comm 350' NE fr W ang NE 1/2 Lot thence NE 1,850'; SE 1730' SW 200' SE 20' SW 2,000' NW 1,349.35' NE 350' NW 634.65' to p. of c.
408881	Grant	March 17, 1975	April 6, 1975	John Huempfner & Kathe Hyempfner, his wife	Nicholas Kot & Louise Kot, equal shares		NE 1/2 Lot thence NE 1,850'; SE 1730' SW 200' SE 20' SW 2,000' NW 1,349.35' NE 350' NW 634.65' to p. of c.
679554	Grant		February 11, 1987	Kot, Nicholas	Stupart, Robert Douglas and Stupart, Mona JT.	\$335,000	Part 545055
				Stupart, Robert Douglas and Stupart, Mona JT.	Thomas and Jessie Herdes		

# Find a Grave Info



## George Calvert

**BIRTH** 1779  
Ireland

**DEATH** 6 Nov 1857 (aged 77-78)  
Burlington, Halton Regional Municipality, Ontario, Canada

**BURIAL** Nelson United Church Cemetary  
Burlington, Halton Regional Municipality, Ontario, Canada [Show Map](#)

**MEMORIAL ID** 75887257 · [View Source](#)

SHARE SAVE TO SUGGEST EDITS

MEMORIAL PHOTOS 4 FLOWERS 1

Photo added by LL









[Add Photos](#) [Request Photo](#)

[Sponsor this memorial with an exclusive premium layout and no ads.](#)  
Sponsor this page

### Gravesite Details

Thanks to slcuthkmw who took all the pictures. I just put them together

### Family Members

Spouses	Children
 <b>Martha Hopkins Calvert</b> 1789-1828 (m. 1800)	 <b>Edward Calvert</b> 1803-1856
 <b>Mary Land McCarter Black Calvert</b> unknown-1856 (m. 1825)	 <b>Margaret Susannah Calvert Turton</b> 1810-1889
	 <b>Caleb Calvert</b> 1819-1854
	 <b>Almira Calvert Breckon</b> 1821-1885
	 <b>Matilda Calvert Burdick</b> 1823 - unknown
	 <b>Priscilla Calvert Hills</b> 1826-1910
	 <b>Joseph Calvert</b> unknown-1883

Advertisement



## John Gillies

**BIRTH** unknown  
Scotland

**DEATH** 6 Jun 1863

**BURIAL** Nassagaweya Presbyterian Cemetery  
Campbellville, Halton Regional Municipality, Ontario, Canada [Add to Map](#)

**MEMORIAL ID** 157544780 · [View Source](#)

SHARE SAVE TO SUGGEST EDITS

MEMORIAL PHOTOS 1 FLOWERS 3

Photo added by Sharon









[Add Photos](#) [Request Photo](#)

[Sponsor this memorial with an exclusive premium layout and no ads.](#)  
Sponsor this page

### Gravesite Details

Aged 56 Native of Kilmartin Scotland

### Family Members

Spouse	Children
 <b>Isabella Mary McPhail Gillies</b> 1808-1876	 <b>Duncan Gillies</b> 1832-1913
	 <b>Lilly Gillies</b> 1834-1911
	 <b>Archibald Gillies</b> 1838-1908
	 <b>Margaret Gillies</b> 1841-1841
	 <b>John Gillies</b> 1843-1905
	 <b>Mary Gillies</b> 1850-1850
	 <b>Donald Gillies</b> unknown-1860

Advertisement



# 2012 Renovations

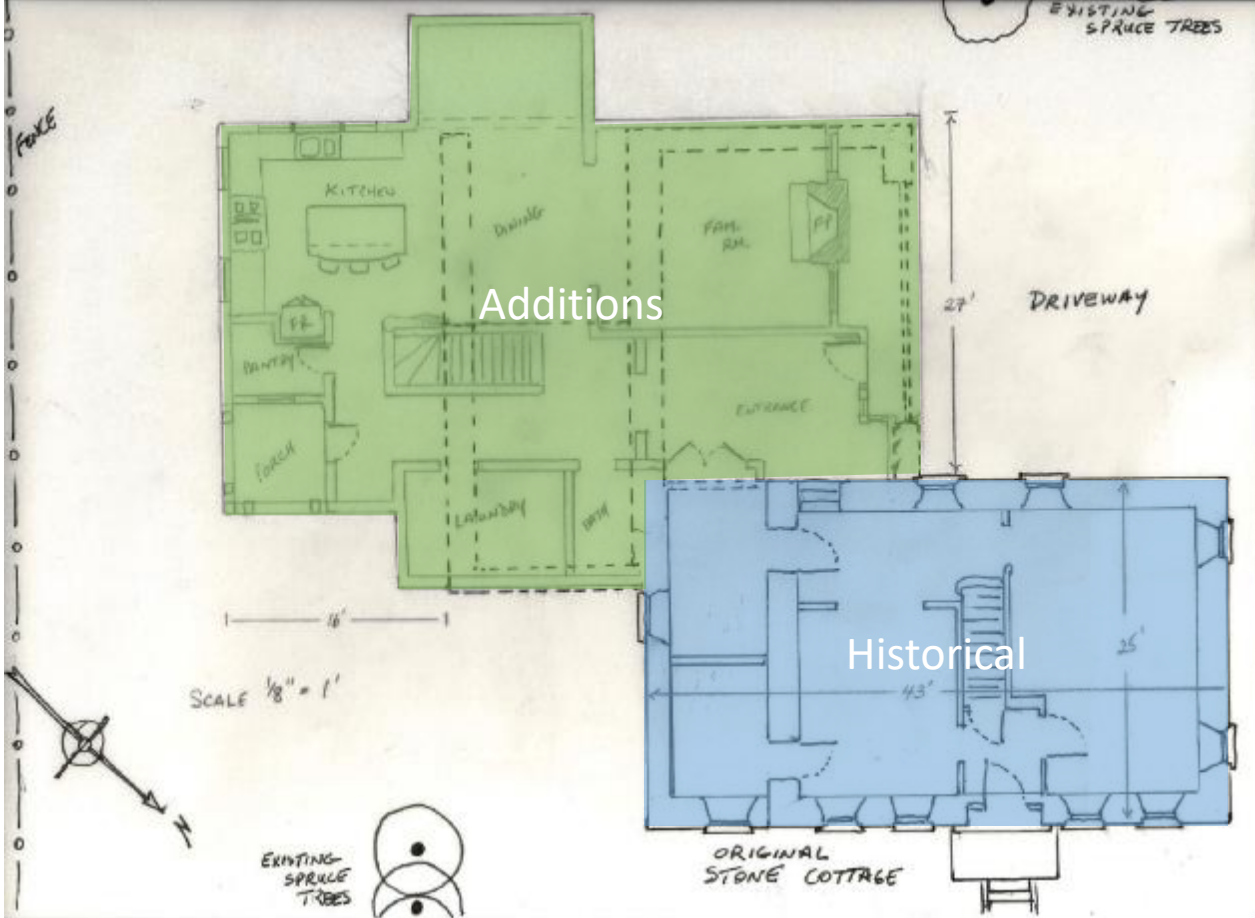
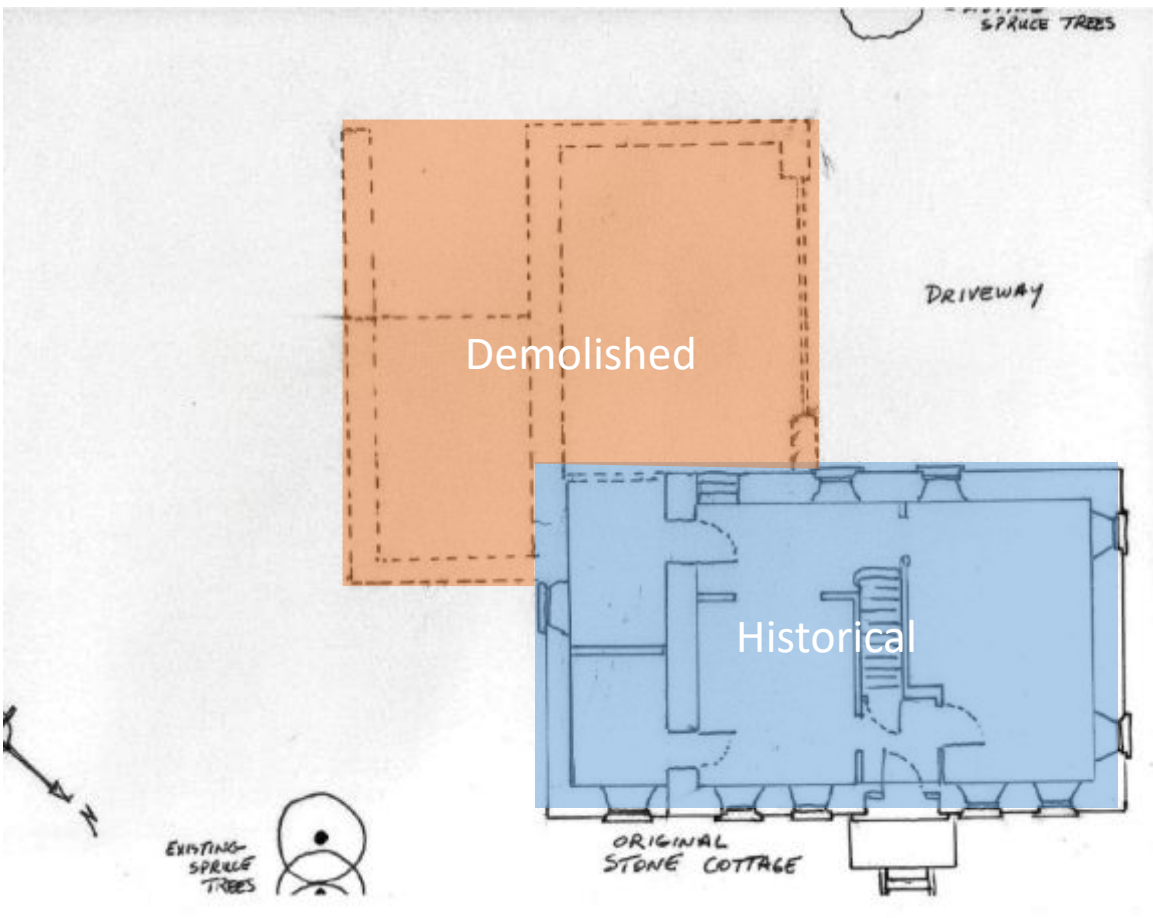



# Proposed Front Elevation (2016)



# 2012 Pictures



# 2012 Pictures

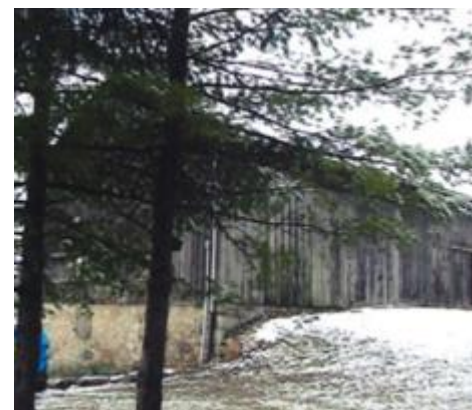

# 2012 Photos



# 2012 Photos



# 2012 Photos



# 2012 Photos



# Comparative Pictures



2024



2023



2021



2020



2018



2011



# 2024 Pictures



North East Elevation (Part addition)



North East Elevation (Historical)



North East Elevation (Historical)



South West Elevation (Rear Addition)



South West Elevation (Rear Addition)



South West Elevation (Rear Addition)

# 2024 Pictures



North Elevation (Historical)



North West Elevation (Historical)



North West Elevation (Addition)



South East Elevation (Additions)



South East Elevation (Additions)



South East Elevation (Additions)

## Physical Attributes

- One-storey Regency Style stone farmhouse with low hip roof, protruding eaves and plain fascia. Front dormer was reconfigured in 2012



## Physical Attribute

- Regular course cut stone at west elevation and random course parged fieldstone at side elevations



## Physical Attributes

- Single flue stone chimney was repaired with grey bricks in 2012



## Physical Attributes

- One-over-one windows with shutters, plain mouldings, stone lintels and lug sills

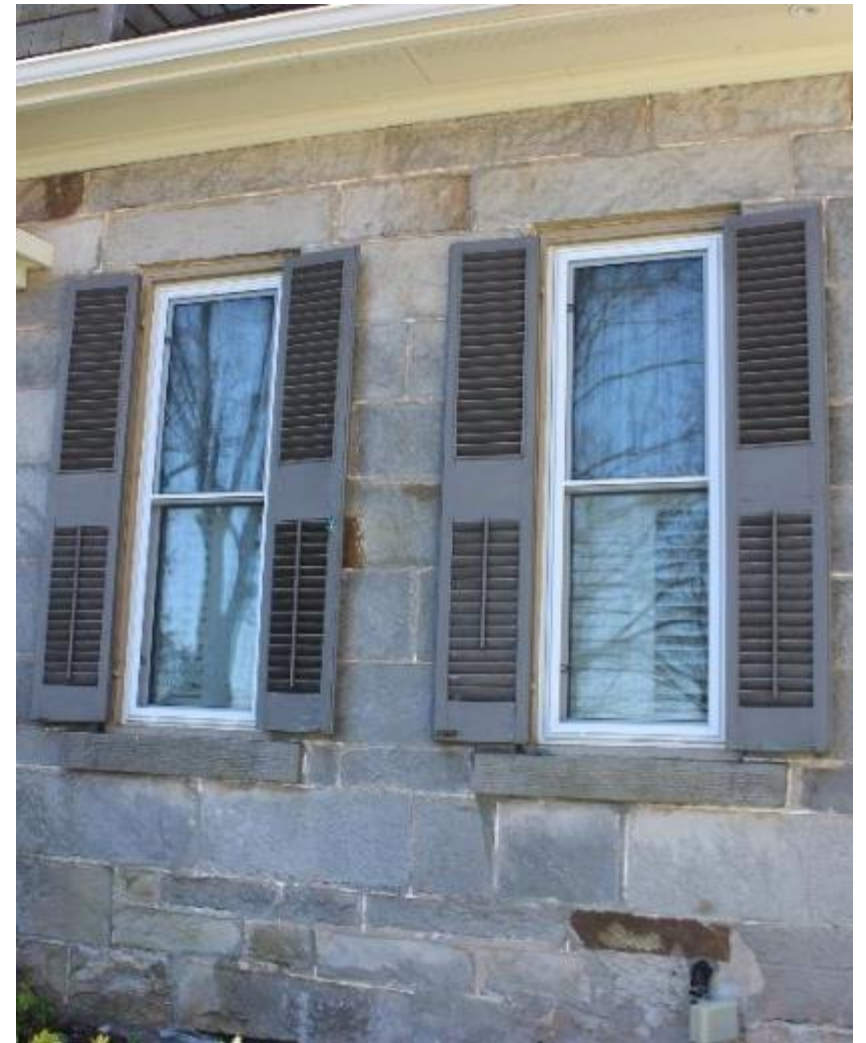

Front Elevation

# Physical Attributes

- One-over-one windows with shutters, plain mouldings, stone lintels and lug sills



Side Elevation

## Physical Attributes

- One over one windows with plain mouldings, stone lintels and lug sills  
Four over one dormer windows are additions



Side Elevation



## Physical Attributes

- Six panels front door with moulded trims, pediment surrounds, side lite and multi-pane transoms  
Dated stone “ GMC 1846 B J F ”



Side Elevation

## Barn (Non-Heritage Attribute)



## Barn (Non-Heritage Attribute)



# Barn Interior (Non-Heritage Attribute)



## Non-Heritage Attribute Barn Interiors

