

**Proposed Dwelling Footprint area
(inclusive of covered porches:
566.7 sq. m.**

**Existing Dwelling
First floor area (inclusive of 3 season room): 113.7 sq. m.
Second Floor area: 63.8 sq.m.
Total Gross Floor Area: 177.5 sq.m.**

**TOWN OF MILTON
DEVELOPMENT SERVICES
A2, GA ZONE
ZONING: REVIEWED FOR C of A
rob.catarino APR 7, 2026
ZONING OFFICER DATE**

GENERAL NOTES:
1. ALL EXISTING DIMENSIONS TO BE CONFIRMED BY THE CONTRACTOR PRIOR TO CONSTRUCTION & PRODUCTION OF PREFABRICATED PRODUCTS SUCH AS PRE-ENGINEERED WOOD TRUSSES. THE DESIGNER MUST BE NOTIFIED OF ANY MAJOR DISCREPANCIES BEFORE WORK COMMENCES
2. ALL CONSTRUCTION TO CONFORM WITH THE LATEST VERSION OF THE ONTARIO BUILDING CODE.

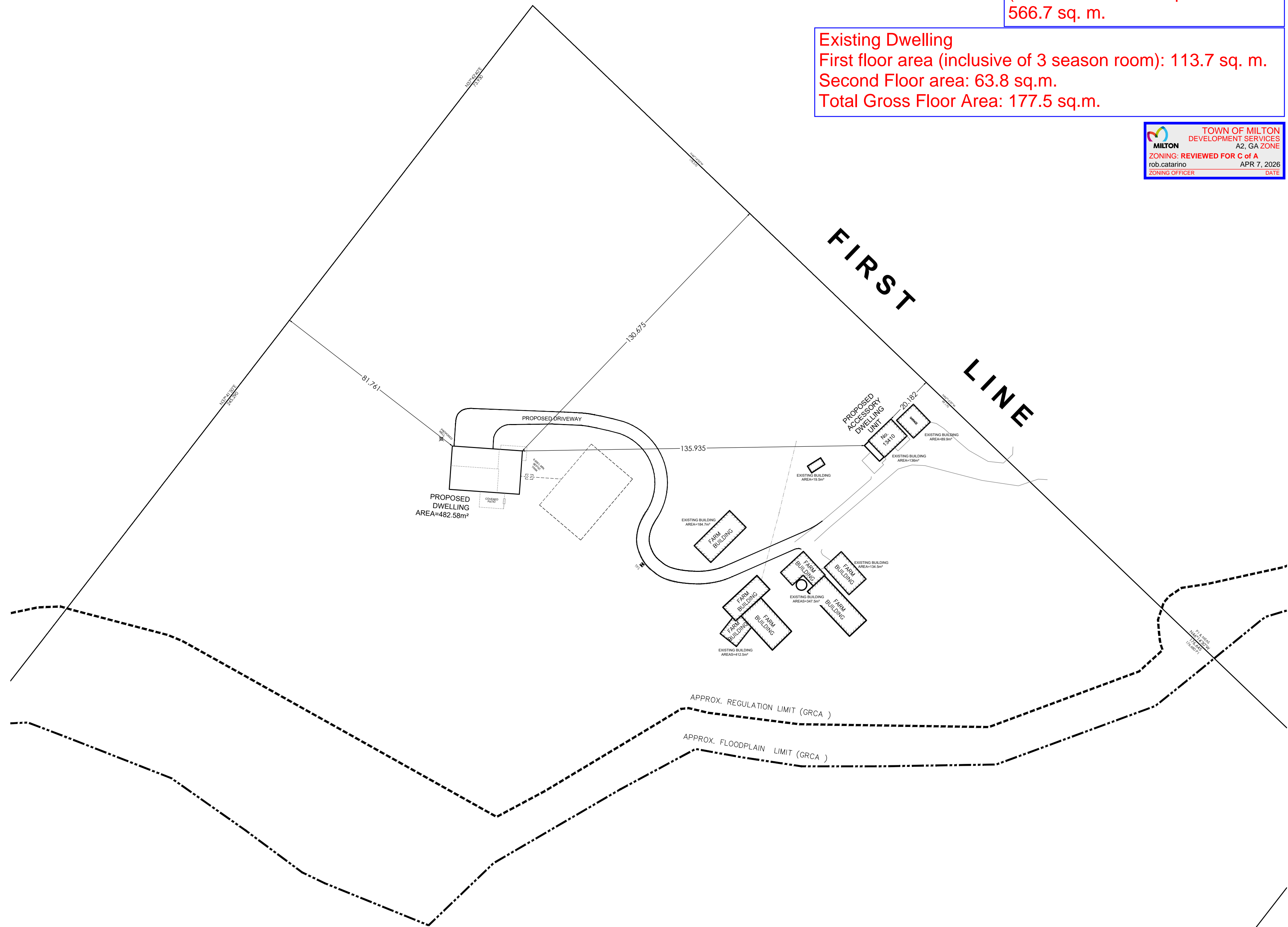

..\\..\\Logo\Design\Logo-4.7.2017.jpg

SITE PLAN
SCALE : 1: 150

PROPOSED BUILDING & ADU
ADDRESS: 13410 FIRST LINE NASSAGEWEYA,
MILTON, ON

MATT JESSUP

CLIENT

SPI