



The Corporation of the Town of Milton

Report To: Council

From: Andy Scott, Director, Strategic Initiatives & Business Development

Date: October 7, 2024

Report No: ES-032-24

Subject: MEV - Post-Secondary Update - Wilfrid Laurier University

Recommendation: THAT this report is received for information.

EXECUTIVE SUMMARY

- The Milton Education Village (MEV) is a key strategic initiative that supports our future growth, the achievement of our corporate Strategic Plan and our Vision of Milton in 2051.
- Construction activity on the Milton Education Village has commenced with site readiness work underway by Wilfrid Laurier University and Phase 1 construction by Schlegel Villages.
- Conestoga College and Wilfrid Laurier University have secured interim spaces across Milton to commence offering post-secondary academic programming.
- Three campuses are now open with a combined capacity of over 3,000 students.

REPORT

Background

In the early 1990's the Town identified the need to attract post-secondary educational institutions to the community and in 2007 the Town began to assess the potential of municipally owned lands as a local post-secondary campus location with related and complementary uses.

Since that time, work has progressed with a range of academic, landowner and government partners to plan for the property to the west of urban Milton to become a complete transit-oriented community centred around a large academic post-secondary campus with

Background

complimentary commercial, residential and community use space, The Milton Education Village (MEV).

Discussion

2024 has seen Wilfrid Laurier University continue with their site works to prepare for a future ground-breaking while Schlegel Villages has commenced construction and broken ground on phase one of their Villages of Ridgeview Court Long Term Care/Independent Living Facility.



Wilfrid Laurier - Milton One site readiness activities



Schlegel Villages - Village of Ridgeview Court development

Discussion

Coordinated land planning work with the landowner group has continued with particular focus on the Sub-Watershed Impact Study (SIS). During its development and review landowners have continued to refine their neighbourhood and campus masterplans.



Wilfrid Laurier Campus rendering



Conestoga College building rendering

Discussion

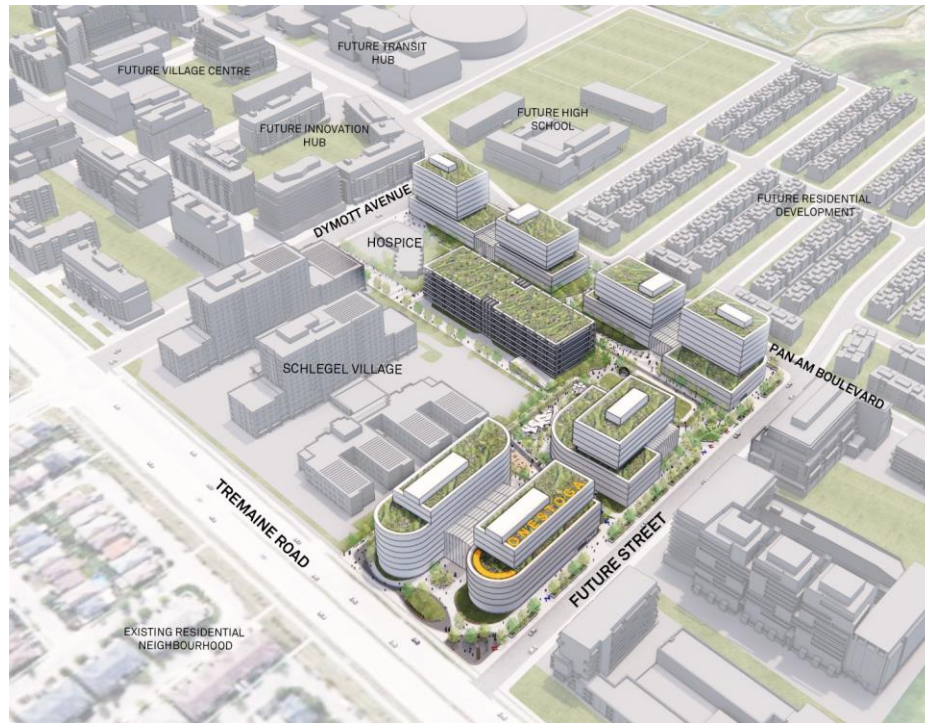

Conestoga College North Campus rendering

Interim Campus Spaces

2024 saw Conestoga College and Wilfrid Laurier University launch three interim campus spaces.

- Conestoga College - Park Hill Campus
- Conestoga College - Steele Ave Campus
- Wilfrid Laurier - Laurier Milton Academic Centre

May 2024 saw Conestoga College open its Steeles Avenue Campus which is a Centre of Excellence in Health and offers a range of healthcare focused programming in experiential lab



Discussion

These campuses are fully operational and offer a range of post-secondary degree, diploma and certificate programming. Across all campus locations Milton now has capacity for approximately 3,100 post-secondary students.

To facilitate student movement around the community, the Town has entered into a transit partnership with both post-secondary institutions which has seen investments into our Milton Transit service. Route 1 offers conventional transit service connecting our three campus locations to the Milton Go Station and the 401 Park and Ride. To coincide with this Milton Transit has also introduced a reduced cost transit pass for students.

Strategic Alignment

'Planned Community Growth' is a key strategic theme as identified within the Town's Strategic Plan; with the MEV a key driver of this community growth. Staff have recently completed a mid-point evaluation of the Town's economic development strategic plan which shows continued growth in the Professional, Technical and Scientific sector as well as growth across the Finance & Insurance and Healthcare sectors. Future attraction and business expansion aligned to these growth sectors will require the development of suitable non-residential space. The Milton Education Village is an ideal location for these sectors given the community and neighbourhood assets that will exist

Financial Impact

There are no financial impacts for consideration within this report.

Respectfully submitted,

Choose an item.

Choose an item.

For questions, please contact:

Phone: Ext.



Attachments

[Click here to enter text.](#)

Approved by CAO
Andrew M. Siltala
Chief Administrative Officer

Recognition of Traditional Lands

The Town of Milton resides on the Treaty Lands and Territory of the Mississaugas of the Credit First Nation. We also recognize the traditional territory of the Huron-Wendat and Haudenosaunee people. The Town of Milton shares this land and the responsibility for the water, food and resources. We stand as allies with the First Nations as stewards of these lands.